



538 NINTH STREET SUITE 240 • OAKLAND, CALIFORNIA 94607 • T 510 625 9800 • F 510 625 9801 • WWW.HKIT.COM • A CALIFORNIA CORPORATION

MEMORANDUM

Date: June 12, 2023

Purpose: ☒ Meeting Minutes ☐ Phone Minutes ☐ Other:

To:
FILE

From:
Felix Hunziker

Project Name:
Kennedy HS Pre-Design

Project Number:
23018.0

Subject:
KHS Steering Committee Meeting #1
5/30/23 @ 5:00PM virtual meeting

File: ☐ JF ☒ CF ☐ CCF

Attendees:

Ellen Mejia Hooper
Tim Haley
Summerlyn Sigler
Miesha Harris Gash
Ian Bader
Maria I Ponce
Arianna Morales
Mike Peritz
Benjamin Carpenter
Goldie Williams
Jeff Evans
Joey Favaloro
Felix Hunziker

Company

WCCUSD, Director Facilities Planning & Construction
IEP2, Design Manager
Exec. Dir. Of Secondary Schools
KHS Spec Ed Teacher
KHS Librarian & Teacher
Parent
Parent
Retired KHS Teacher
KHS Welding Teacher
Community Member
HKIT, Principal
HKIT, Project Architect
HKIT, Project Manager

Notes:

1. Master Plan process recap:
 - a. MP process developed several options but there's not enough funding.
 - b. Board directed staff to proceed with a project of significant scale, hire an architect to define scope within reduced budget.
 - c. District communications were limited due to procurement process rules.
 - d. HKIT was hired for Pre-Design scope/budget studies.

2. Group Q&A: “What is the most important quality that the newly renovated KHS achieve?”
 - a. That during this transition students have a sense of belonging, feel connected. Have a place for them, where they can fit in.
 - b. Form follows function, function is ambiguous, waiting to know more about the future of the school. Vocational pathways have needs that affect architecture, from simple things like toilet rooms to insufficient classroom access.
 - c. That students feel a sense of pride and place in the new buildings.
 - d. Equity and inclusion. Compare to ECHS, DeAnza HS. We need windows, and a multi-use facility for sports.
 - e. School should be in a condition where students don’t feel left out compared to other schools. Visually pleasing. Provide college readiness and for other career tracks.
 - f. All of the above. Would like a school for her children, a place where staff are inspired to work, a place that students are proud of, a place that provides the sense of community that’s lacking outside the campus.
3. Group Feedback: “Should the Main Office be centralized or decentralized?”
 - a. The office is not a singular entity; includes Principal, Vice-Principals, Attendance, Mental Health, Registrar, Counseling, etc. Do they stay together or decentralize?
 - b. Current building design is flawed: having offices underneath classrooms is noisy and distracting. Always consider safety: lines of sight, feeling safe, fewer entry point to reduce anxiety. Prefer decentralized but if centralized then it’s easier to cover if there are staff vacancies. While that’s admittedly a deficit outlook it’s the reality.
 - c. Agree with the above. Change the culture and safety on campus. Put safeguards in place to protect staff. KHS is a vulnerable campus with many soft spots. Make a safe but welcoming front of campus. Nooks & crannies are a supervision problem. Talk to campus security.
 - d. Campus front should be welcoming but safe. Access control may not always feel welcoming but it does make people feel safer. Administration at the front keeps visitors at the entrance as opposed to going on campus. Move mental health and counseling out of Admin for better privacy. Consider the same for Principal and Vice-Principals for better student privacy. There are many opportunities around the campus for planting/greenery to make the space more pleasant.
 - e. Admin functions should be easy to access from the parking lot and entrance, they shouldn’t be confusing or too far for the mobility-impaired. Staff and visitor parking currently requires a circuitous route to the campus entrance.
 - f. Counseling includes academic, career, and health. Within Spec Ed a psychologist also offers counseling. Academic counselors collaborate with Admin, health counselors are confidential. They should remain separate.
 - g. College and Career Center is usually staffed by someone from UCB. How will community school goals affect design? What does that look like?
 - h. There’s only 1 conference room area right now, seats 10. We need a couple other spaces for meetings, special meeting rooms for IEP and for large staff meetings. De Anza HS received such facilities.
4. Group Feedback: “What programs or spaces should be at the front of campus (Cutting Blvd)?”
 - a. Showcase CTE at Cutting, design the façade so the public is informed about the CTE programs that KHS offers.
 - b. Perhaps a space for a community room?
 - c. Celebrate KHS’s uniqueness.
 - d. *District: how about a retail shop at the front of school, perhaps selling Fab Lab or welding shop products? Or a helpdesk for the community? CTE programs will change over time.*
 - e. The FMP looked at relocating CTE. In a scaled down project is that even feasible? There have been recent improvements in the welding and wood shop labs. *District: nothing is decided yet but given the reduced budget and recent improvements it may not be high on the priority list.*
 - f. Will there be opportunities to explore adjacencies, what programs go into which buildings? *District: we’ll be doing that at some scale later, once the options become clearer.*

- g. Would like to add a museum space for old KHS items.
 - h. There is a memorial tree planted at the front of the campus. The plaque was stolen but the tree should be protected or relocated.
5. Group Feedback: “Which buildings would you replace and why?”
- a. With community schools the school becomes layered like an onion, with the safest place at the center, visitors at the edges. Looking at equity, we only have 1 Gym and the fields are used a lot; how will the community access athletics? What is a community school and how many entrances does it have? Perhaps the west side is open on weekends, the east side only when school is open. A few of the buildings will need to be replaced if we’re going to become a community school. *District: the 900 Buildings are smaller and very old, they will be removed to improve access and supervision before moving the 100/200 Bldg. occupants.*
 - b. Need to display and showcase student work, 2D and 3D, indoor and outdoor.
 - c. The welding program needs a fireproof extension, it doesn’t need a new building. Fab Lab also needs that fireproof area.
 - d. Welding lab was renovated in 2017 but is inadequate for a Pathway. Staff can only teach 1 welding class, there are 2 other welding classes that should be taught but they have different needs that aren’t met.
 - e. Would like to see the 300 Building stay but be refreshed/modernized. The faculty workspace is treasured but the Library needs to be brought into the 21st century.
 - f. Agree with the above; the “K” is for the kids, the faculty loves the staff lounge and atrium.
6. Next Steps:
- a. Site investigations in June.
 - b. Critical Needs Project is separate from Pre-Design and is moving forward. This project relocates critical low voltage systems in the 100/200 Building and moves those occupants into portable buildings next Summer.
 - c. Pre-Design: studying options and cost to bring to stakeholders in the Fall. Construction timeline is currently hard to predict as we are in the scope and budget phase. Unlike Coronado this will be a phased project.

Cc: Ellen Mejia Hooper, WCCUSD
 Tim Haley, IEP2 (for distribution)
 Jeff Evans, HKIT
 Joey Favaloro, HKIT
 Amy Fine, HKIT

John F. Kennedy High School

Steering Committee Meeting #1
May 30, 2023

HKIT ARCHITECTS



A grayscale image of an hourglass with sand falling from the top bulb into the bottom bulb. The hourglass is centered vertically and horizontally.

agenda

team introductions

feedback

next steps

our team



Please introduce yourselves?

What is the most important quality that the
new/renovated KHS achieve?



Jeff Evans
Principal-in-Charge



Felix Hunziker
Project Manager



Joey Favaloro
Educational Design Project
Architect



Rod Henmi
Director of
Design



Alma Davila
Designer

Vanden Baysa
Senior Designer

feedback



What programs or spaces should be at the front (Cutting) of campus?

What are pieces of the existing schemes you love? Could do without?

Should the Main Office be Centralized or Decentralized

Which buildings would you replace and why?

What was most important to you in the masterplan? Least important?

existing
site

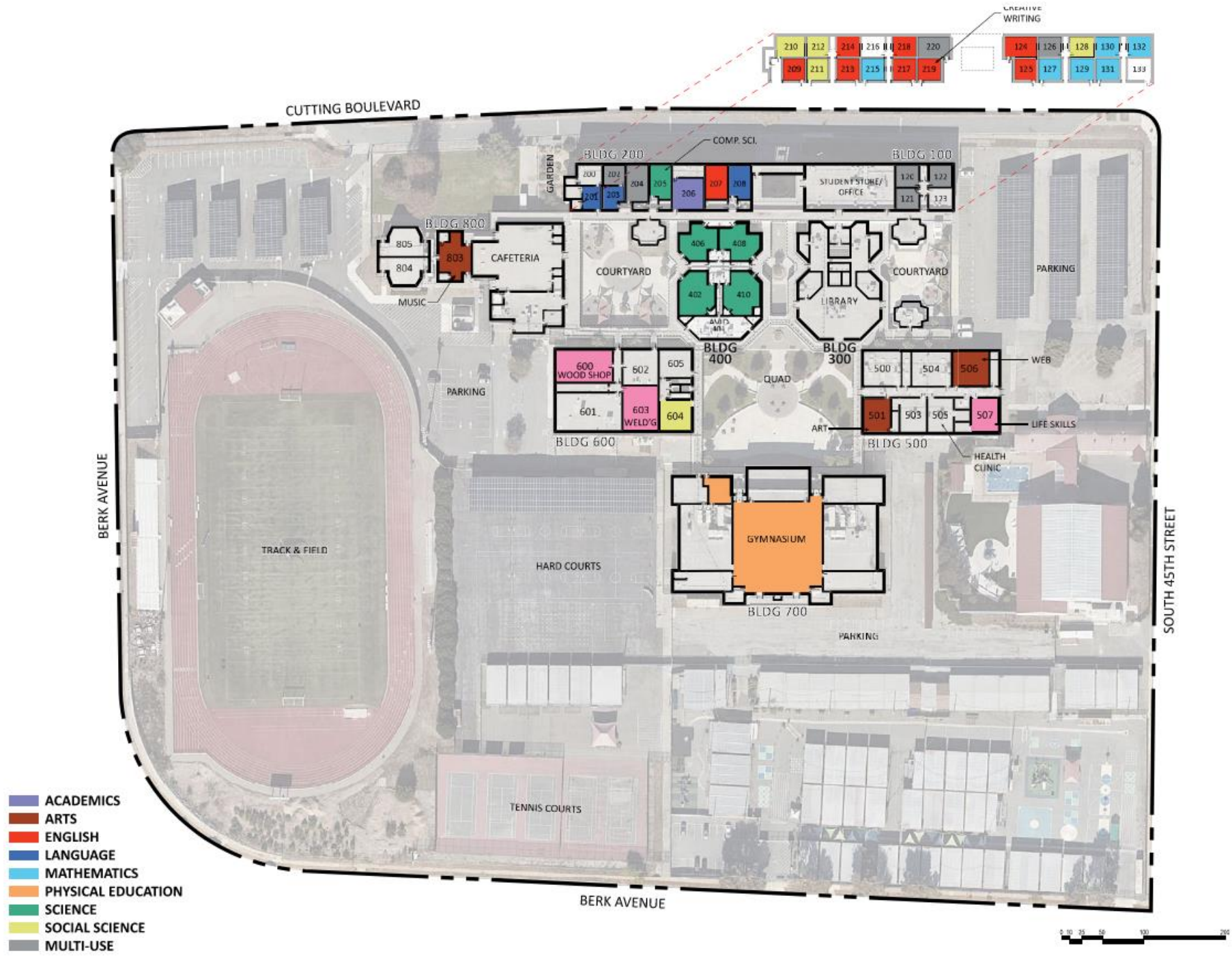

next steps

- **Site Investigation**
 - This Summer
- **Critical Needs Project**
 - Schematic Design This Summer/Fall
- **Pre-Design Phases 1 & 2**
 - Working with District on Options over the Summer
 - Review Options in the Fall with cost info

THANK YOU

We are ready to
soar with you!

